

U.S. Green Building Council, HQ Renovation

Washington, DC
Date of Completion: 10/06/2021

Jury Citation Categories

Equitable Communities
Well-being
Resources
Energy

Project Statement:

The new headquarters for the United States Green Building Council embodies their brand and mission to reduce the negative impacts of the built environment while promoting health and well-being with a focus on enhancing the human condition. As a result in an evolution of how the organization used the space, the USGBC looked to reduce their footprint and consolidating into one section of their existing space. The space is divided into two areas, one is a refresh of the existing office staff workspace, and the second is a new public facing collaboration area, that demonstrates an evolution of the USGBC brand.

Design Narrative: How does this project address Design for Integration, Wellbeing, and Discovery?

The new USGBC headquarters is a showroom for all that the organization does. A ribbon wall featuring an abstract image of wetlands gently embraces the public space and symbolizes the connectedness of sustainability, resilience, biophilia, and human well-being. The space provides the opportunity for organizational members, partners, and staff to be celebrated for their collective contributions in the industry. Hospitality and meeting areas serve as convening and community space for groups to gather, share experiences, and collaborate in the interest of a positive future. The space can also be used as an educational tool where all materials are featured in the knowledge center, giving visitors and staff the opportunity to learn about the sustainable and human-centric design. A media wall with a multi-screen digital display showcases project case studies and metrics for visitors.

Community Engagement: How does this project address Design for Equitable Communities and Economy?

The project leveraged our teams early partnership with EC3 to research and specify materials with low embodied carbon impact and was the first client project in the DC studio to complete a Life Cycle Assessment. This provided an opportunity to expand the LCA skillset in the DC studio and further refine our process for reducing embodied carbon in interiors.

The office is innovative, functional, and durable. Designed to promote health and well-being with a focus on enhancing the human condition, the design reflects progressive office design strategies including mobility, collaboration, and the integration of technology.

Sustainability and Resilience: How does this project address Design for Ecosystems, Water, Energy, Resources, and Change?

Material selection in USGBC's space focused on reducing greenhouse gas emissions through supporting a circular economy. The office exemplifies and address circularity with its material reuse and repurpose – 80% salvaged furniture, partitions, doors, and ceilings. Where new materials were required, priority was given to products with third-party transparency documentation and low embodied carbon. These combined strategies led to a 44% reduction in embodied carbon from baseline.

Ultimately, the project reduced Lighting Power Density (LPD) by 57% and reduced Water Use Intensity (WUI) by 41% from baselines in alignment with the AIA 2030 commitment for commercial interiors. The project is seeking certifications from LEED, the WELL Building Standard, and on track to become the first TRUE certified Zero Waste project, further supporting circularity by completely eliminating landfill waste.



The new USGBC headquarters is a showroom for all that the organization does. A ribbon wall gently embraces the public space and symbolizes the connectedness of sustainability, resilience, biophilia, and human wellbeing. People will come here to exchange ideas and collaborate in the interest of a positive future.

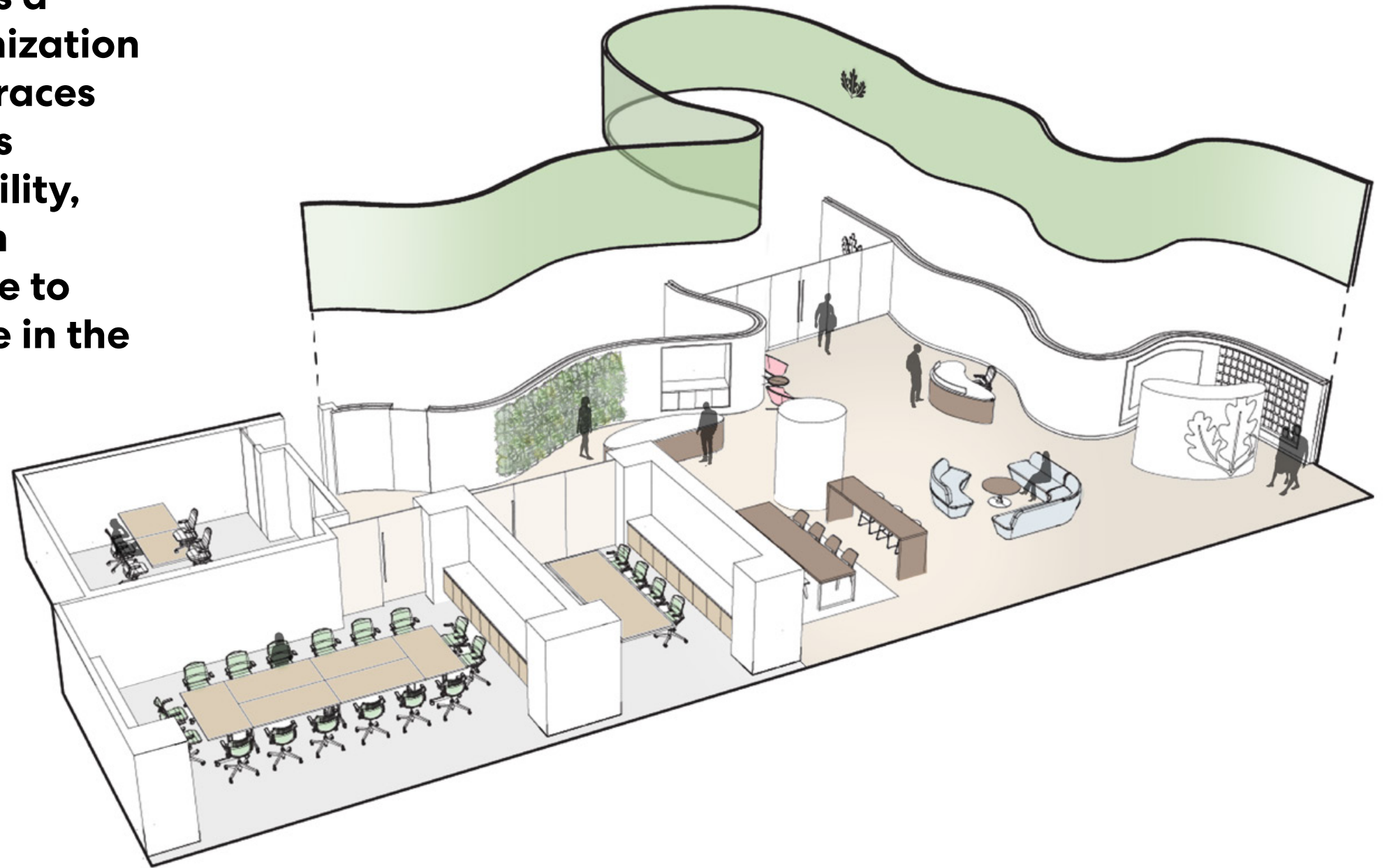

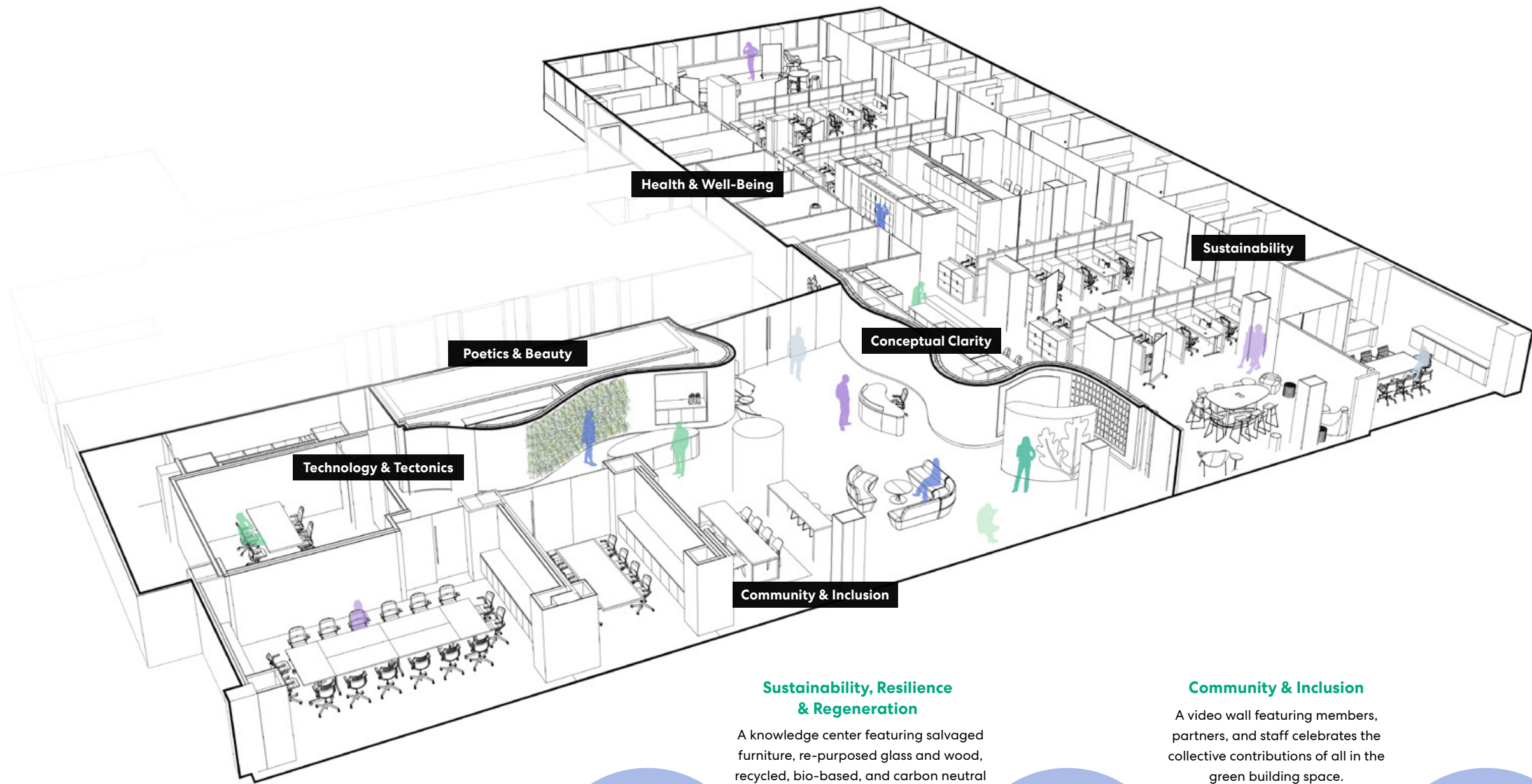

Sustainability, Resilience & Regeneration

A knowledge center featuring salvaged furniture, re-purposed glass and wood, recycled, bio-based, and carbon neutral materials used throughout the space.

Community & Inclusion

A video wall featuring members, partners, and staff celebrates the collective contributions of all in the green building space.

Poetics & Beauty

The use of natural materials, soft curves, and biophilic elements paired with an emphasis on carbon reduction creates a space demonstrating USGBC's future organizational goals.

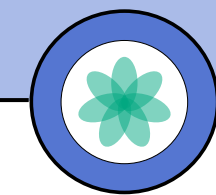

Conceptual Clarity

Visitors and staff are greeted with soft curves and biophilic imagery representing an evolved USGBC, focused on enhancing the human condition.

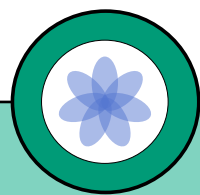

Health & Well-Being

Varied work settings, spaces for meditation and respite, as well as height-adjustable workstations introduce health & well-being strategies throughout the space.

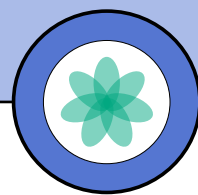

Technology & Tectonics

A repurposed wood feature wall from USGBC's previous space exemplifies material circularity in visitor and staff areas.

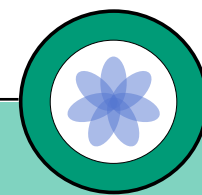





Where flowers bloom, so do
troubles. Let the beauty of
this world fill your heart. You cannot escape it.
No Plan B because there is
no other. We make a
mistake of the mind, not
of the heart. We may
greatest use of a life is to
only what we give remains.
ounce of practice is worth
to earth. (Ole) I will
who? And if not now, when
change you wish to see in
it's all that ever has. -Wise
and wonder at the meaning
Sustainability without equity
limited imaginations. (Ole)
who's well, as scientists or
the. (Ole) I will
you cannot keep spring
Fight for the things that you



Where flowers bloom, so does hope. - Lady Bird Johnson To plant a garden is to believe in tomorrow. - Audrey Hepburn Let the beauty of what you love be what you do. - Rumi I don't want to believe, I want to know. - Carl Sagan You cannot escape the responsibility of tomorrow by evading it today. - Abraham Lincoln There can be no Plan B because there is no planet B. - UN Secretary-General Ban Ki-moon The Earth is what we all have in common. - Wendell Berry We make a living by what we get, but we make a life by what we give. - Winston Churchill The pessimism of the mind; optimism of the will. - Antonio Gramsci There can be no stewardship without stewards. - John Jay Jackson Jr. We may encounter many defeats but we must not be defeated. - Maya Angelou The greatest use of a life is to spend it on something that will outlast it. - William James What we keep we lose; only what we give remains our own. - Motto - St. Catherine's School (1825) A good traveler leaves no tracks. - Leo Tzu An ounce of practice is worth more than tons of preaching. - Mahatma Gandhi Earth does not belong to us; we belong to earth. - Chief Seattle Integrity, decency, and a sense of other people's needs. - Barack Obama If not us, who? And if not now, when? - John F. Kennedy Always maintain only a joyful mind. - Chelucco Yeshe Dorje Be the change you wish to see in the world. - Mohatma Gandhi Never believe a few people can't change the world. it's all that ever has. - Margaret Mead No one belongs here more than you. - Brent Browndrink in the beauty and wonder at the meaning of what you see. - Rachel Carson What we love we must protect. - Sandra Scragruber Sustainability without equity is sustaining inequity. - Tamara Toles O'Laughlin Never be limited by other people's limited imaginations. - Dr. Mae Jemison The Earth is a fine place and worth fighting for. - Ernest Hemingway Those who dwell, as scientists or laymen, among the beauties and mysteries of the earth are never alone or weary of life. - Rachel Carson I believe in using all the colors in the crayon box. - Rud Paul You can cut all the flowers but you cannot keep spring from coming. - Pablo Neruda Honor the hands that harvest your crops. - Dolores Huerta Fight for the things that you care about, but do it in a way that will lead others to join you. - Ruth Bader Ginsburg

Wood Flooring Finishes



reSAWN Timber Co. | North American White

Reclaimed Wood Flooring

LOCATION/PROJECT
Reception 1 Hospitality Area

SUPPLIER	reSAWN Timber Co.
SPECIES	North American White Oak
USE	Rift & Quarter
STAIN	Savannah
FINISH	Matte Polyurethane Pre-Finished

MANUFACTURING LOCATION
Savannah, Georgia

HEALTHY + ENVIRONMENTAL ATTRIBUTES
FSC Certified



Knowledge Library

The Knowledge Library is a public-facing resource that showcases the full inventory of innovative products and materials installed on the project (including an assortment of items reused). The material cards are double-sided and printed on FSC certified paper board made of wood pulp. Material specifications are listed on the backside, displaying human health + environmental benefits.





Hospitality Bar

“Our new USGBC headquarters is a showcase for our mission and a working demonstration of green building leadership,”

Peter Templeton, President & CEO

U.S. Green Building Council and Green Business Certification Inc.



Salvaged Table & Chairs

FSC Certified Wood Flooring

Carbon Neutral Carpet



Image from USGBC's previous space on the 5th & 6th Floor.

Podcast Studio

Forming the backdrop to the public space, reused pieces from the original U.S. Green Building Council wood paneling were repurposed outside the Podcast Studio. Working with the contractor on site, individual panels were selected to maintain parts of the engraved logo. An acoustically rated window allows guests to peek in and watch while podcasts are recording.



Reused USGBC Logo

Salvaged Colored Glass

Salvaged Meeting Chairs

Carbon Neutral Carpet



Salvaged Workstations

Salvaged Task Chairs

Height Adjustable Desks

Salvaged Bar Stools

Salvaged Community Table





Salvaged Ceiling Tiles

Salvaged Glass Office Fronts

Salvaged Office Furniture

Carbon Neutral Carpets

Floor Plan

Level 06

USGBC's Headquarters space employs circular design within their project scope by reusing over 80% of the furniture installed within the space.

Legend

- 1 Reception
- 2 Knowledge Library
- 3 Video Display
- 4 Hospitality Bar & Living Wall
- 5 Conference Room
- 6 Podcast Studio
- 7 Open Collaboration
- 8 Staff Pantry
- 9 Staff Conference
- 10 Focus Room
- 11 Wellness Room

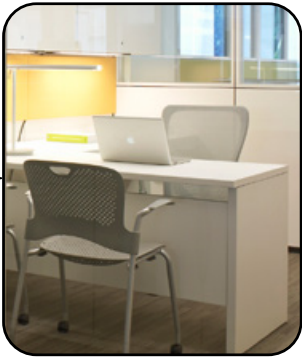

Offices & Workstations
All Private Offices & workstations were reconfigured to accommodate new sit to stand desks within the existing casegoods.



Ancillary Furniture
Ancillary pieces were pulled from USGBC's prior tenant space along with their partner organization ARC.



Conference Furniture
Training tables and conference chairs were reused from the existing tenant space.

